

QuickTool Changer Series FOUK-QTC

QTC75

QTC75

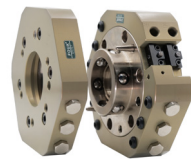

Static Torque

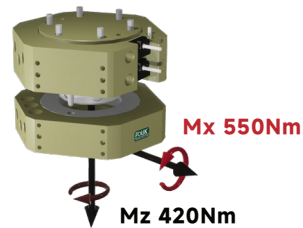

Specifications	QTC75-M	QTC75-T	Unit
	Robot-Side Tool Changer Tool-Side Tool Changer		
Weight	2	0.9	kg
Lock/Unlock main connection	G1/8	Locking Force(0.6MPa)/N	7500
Payload/kg	75	PermittedTemperature /° C	5~60
Repeat Accuracy/mm	0.015	IPRating(When fitting)	67
Working Air Pressure Range/Mpa	0.45-0.80	Numbers and features of pneumatic feed-throughs	9 × G1/8
Mechanical Self-Locking	Standard Configuration	Open/Close Detection	Optional Configuration

Accessories	Prcutre	Module Type	Model	Compatible Models	Parameters
Electrical Module		Signal Module	EM-19-M	QTC75-M (Robot Side)	50V, 3A, 19-pin
			EM-19-T	QTC75-T (Tool Side)	50V, 3A, 19-pin
		Communication Module	EM-TR-M	QTC75-M (Robot Side)	60V, 2A, 100Mbit/s
			EM-TR-T	QTC75-T (Tool Side)	60V, 2A, 100Mbit/s
		Power Module	EM-P-M	QTC75-M (Robot Side)	300/500V(AC/DC), 13A, 14pin
			EM-P-T	QTC75-T (Tool Side)	300/500V(AC/DC), 13A, 14pin

Accessories	Prcutre	Type of medium	No. of fluid feed-throughs	Max. operating pressure	Model	Compatible Models
Air Module		Air, vacuum	8 × M5	0.8Mpa	PF-LM-M5-8	QTC75-M (Robot Side)
					PF-LT-M5-8	QTC75-T (Tool Side)

Accessories	Prcutre	Model	Compatible Models	Parameters
Cable		EM-50V-19-LW4	EM-19-M(Robot Side)	19-pin,Cable length 4m Right-Angle
		ET-50V-19-LW2	EM-19-T(Tool Side)	19-pin,Cable length 2m Connector

Accessories	Prcutre	Model	Function	Parameters	Recommended Quantity
Sensor		HS2-S04-P01	Quick-Change (Open/Close)Detection	(NO),3-pin,Cable length2m,PNP	3
		HS2-S04-N01	Quick-Change (Open/Close)Detection	(NO),3-pin,Cable length2m,NPN	

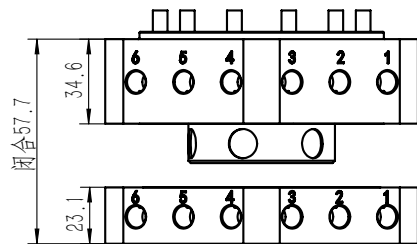

- Ⓐ A-side Module Mounting Surface
- Ⓑ B-side Module MountingSurface
- Ⓒ Compressed Air Connection
- Ⓓ Pneumatic feed-throughs
- Ⓔ Inductive Proximity SensorLocation
- Ⓕ Quick-change Surface Fitting Detection Position
- ① Hex Socket Counterbore Screw (Standard)
- ②③ Robot Side Locating Hole
- ④ Tool Side Locating Hole
- ⑤ Tool Side Mounting Hole

QTC75-M

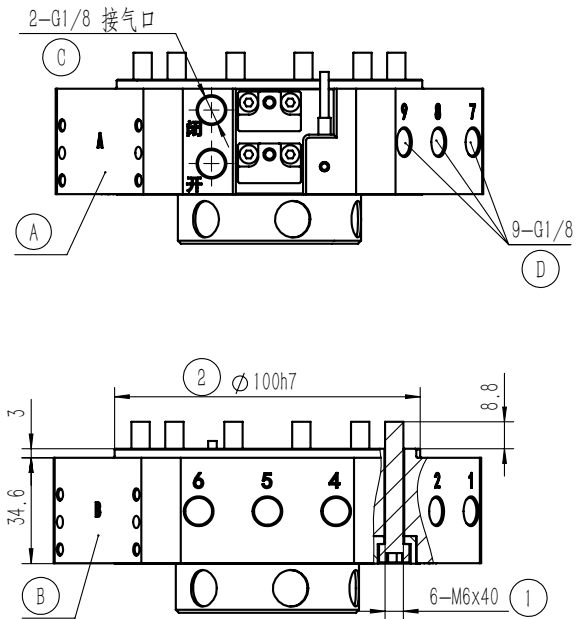
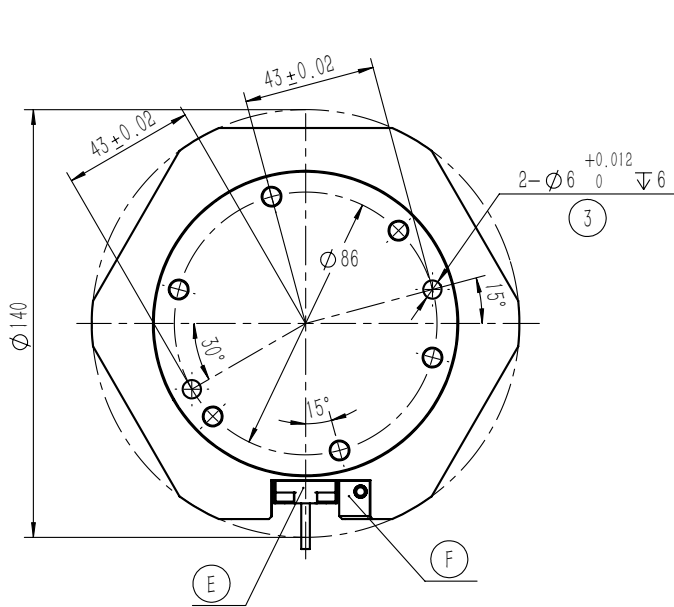

QTC75-T

